



Simplified

KA-SP Wireless Keypad
Security is just a touch away
User Manual



Scan for more help!

Preface

Dear customer,
Thank you for purchasing this product. To make better use of it, please read this manual carefully. If you have any doubt regarding to installation or maintenance, please feel free to contact your local agent.

Specifications

Model :	KA-SP
Dimensions :	W67.7mm x H96.3mm x T29.9mm
Power :	4 AAA
Voltage :	3V
Standby power consumption :	<10 μ A

Accessories

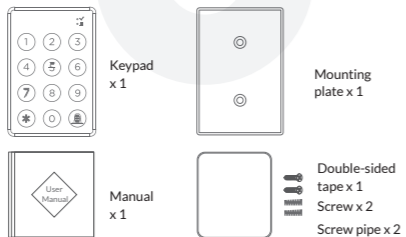

Installation

***If the mounting surface is flat and smooth, please use the tape to secure the keypad. In this case, the mounting plate is not needed.**

***If the mounting surface is uneven, following installation shall be applied.**

- 1 Draw positioning marks on the mounting surface according to the dimensions of the keypad and drill screwholes accordingly.
- 2 Fix the mounting plate with the screws. Use the screw pipes when necessary.

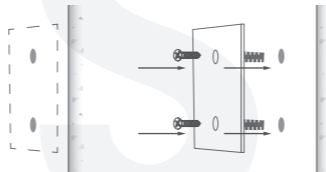

- 3 Glue the keypad on the mounting plate with the double sided tape.

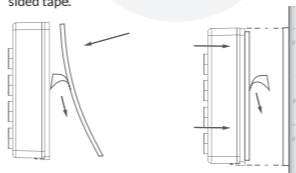

Battery installation

- 1 Remove the screw, squeeze the clamp and pull the battery holder out.



- 2 Load 4 AAA batteries correctly, squeeze the clamp and push the battery holder into the compartment, then tighten it with the screw.

Pair a keypad

- 1 Enter pairing mode
 - If the keypad is not paired to any lock, press any key to enter pairing mode.
 - If the keypad has paired to a lock previously, press *529# to enter pairing mode.

- 2 Add a keypad to a lock

On the APP, select the lock that supports wireless keypad, press Settings→Wireless keypad→Add wireless keypad, and then follow the steps prompted to finish the pairing process.

Operations

- 1 Unlock with passcode

Key in passcode and end with "#".
If the passcode is correct, the green LED lights up for 2 seconds, and the keypad gives a long beep.
If the passcode is incorrect, the red LED lights up for 2 seconds, and the keypad gives 4 short beeps.

- 2 Turn on/off the sound of the wireless keypad

On the APP, select the lock that is paired with the wireless keypad, press Settings→Lock Sound→Turn on/off

- 3 Low battery alert

When the battery is low, the battery alert LED lights up as soon as the wireless keypad is activated, and it dies out after the keypad is deactivated.

Reset the keypad to factory mode

At times of need, the wireless keypad can be reset to factory default mode by applying following steps:

- 1 Remove the rear cover of the keypad
- 2 Long press the reset button for 3 seconds till it gives a beep.

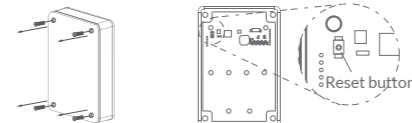

Light Status

When the batteries are loaded:	Status light	Low battery alert
Correct passcode: Green LED lights up for 2 seconds	•	—
Incorrect passcode: Red LED lights up for 2 seconds	•	—
Press any key, Green LED flickers 1 time	•	—
Unable to connect to a lock: Red LED flickers 3 times	•	—
Low battery: Low battery alert LED lights up	—	—
Pairing mode: The green light keeps flickering	•	—

Limited Warranty

1. For any defect in material and workmanship, the original purchaser of the product can:
 - 1) Return or ask for a replacement within 7 invoice days.
 - 2) Ask for free repair in 365 invoice days.This warranty does not cover defects caused by modification, alteration, misuse or physical abuse of the product.
- 2.

Disclaimer

We continuously optimize products as new technologies and features are developed. For this reason, we reserve the right to make alterations to the products without prior notice.



Discover our Range of Products:
Simplified is a London-based tech company rolling out innovative IoT devices to elevate the smart home experience. Control your home with a range of smart security devices from Simplified. Whether it's a Smart Door Lock, a Camera Doorbell, Simplified put you in control of your home security.

Want more Accessories? Here is all you want:

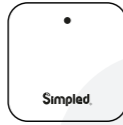

WiFi Bridge

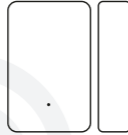

Door Sensor

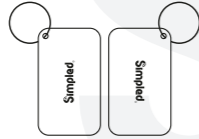

Proxy Fobs
(Contactless Key)



Bluetooth
Remote Controller



Phone Tags
(Contactless Key)



Alkaline Batteries



Covering Plates



Another Smart lock
for other doors



Smart lock for
a friend or family



More accessories?
SCAN HERE

Note



Easy Amazon Review
Scan me!



Contact us



WOW!

We're just happy that you're happy. If you don't know how to express your newfound joy, we've got a few suggestions...



Tell your friends and family

OR



Share your experience by writing a review on Amazon



Connect with us on [simplified.tech](https://www.simplified.tech) Facebook, Twitter and Instagram



MEH.

Our friendly customer service team will work hard to put a smile back on your face.

Here's how we can connect:

✉ support@simplified.tech

🌐 [Simplified.uk/support](https://www.simplified.tech/support)