

Simplified[®]

Simplified, for peace of mind!



User Manual : BF-SPS
Simplified Smart Cylinder



Scan for more help!

Security is just a touch away

Simpled®

Simplified, for peace of mind!

User Manual : BF-SPS Simpled Smart Cylinder



Discover our Range of Products:

Simpled is a London-based tech company rolling out innovative IoT devices to elevate the smart home experience. Control your home with a range of smart security devices from Simpled. Whether it's a Smart Door Lock, a Camera Doorbell, Simpled put you in control of your home security.

- Thank you for choosing the Simplified Slim Door Lock. Please
1. Read this manual completely before using the Simplified Slim Door Lock.
 2. Alkaline Batteries are recommended.
 3. Replace the battery when you notice the low-battery alarm.
 4. Keep the Emergency keys outside the house.

Table of Contents:

What's Included	1
Specifications	2
Product Specifications	3
Dimensions	4
Installation Steps	5-6-7
Setting up the Smart App	8-9
Bluetooth Unlock	9
Add fingerprint	10
Add passcodes	11
Passcode Management	11
Create and Send e-Keys	12
e-Key Management	12
Create Admin	13
Programme Card, Proximity Fobs, Phone Tag Stickers	13
Unlocking Records	14
Pair Wireless Key Fob (Bluetooth Remote Controller)	14
Activate Passage Mode	15
Import data from an old Simplified lock	15
How to turn off/on the lock sound?	15
Transfer lock to a new owner	15
Wifi Bridge Pairing	16
Pair the Gateway with APP	16-17
FAQ	18
Accessories	19
Note	20
Contact Us	21

For more information and support on Simplified Slim Door Lock, feel free to contact us:
support@simplified.tech

What's Included?



Smart Cylinder

a



Proximity Fobs

b



Mechanical Key

c



Suction Cup

d



Manual

f

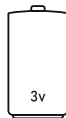

Battery Model:
CR123A(Alkaline)

g



Tool

e

Specifications

Item Name	Smart cylinder lock
Model	BF-SPS
Color	Black/Silver
Material	Aluminum alloy/Brass
Unlock Mode	Mechanical key /Fingerprint /IC card(NFC)/ App
App	TTLock
Support system	Android 4.3/iOS 7.0 Above
Waterproof level	IP5X(Dust and Splash Proof)
Emergency Power	1xMicro Type-C Charging Port
Accepted Door thickness	40 -70 mm *
Power Sourc	1XCR123A(Alkaline)
Working temperature	-20°C ~ 70°C
Working humidity	20~93%RH (no condensation)
Reader Dimension	42x42mm

Note:

*Lengthening rods for thicker doors are available on Simplid store. (Up to 110mm)

Product Specifications

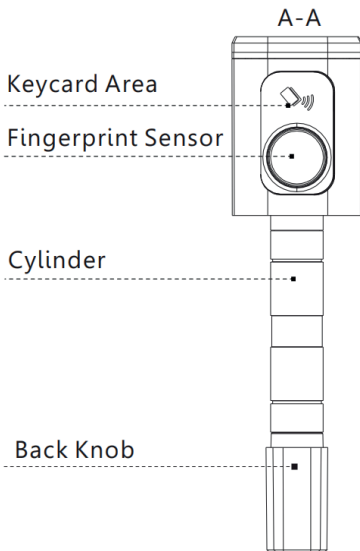

Reader view

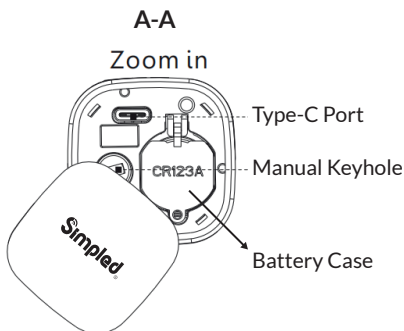

Dimensions

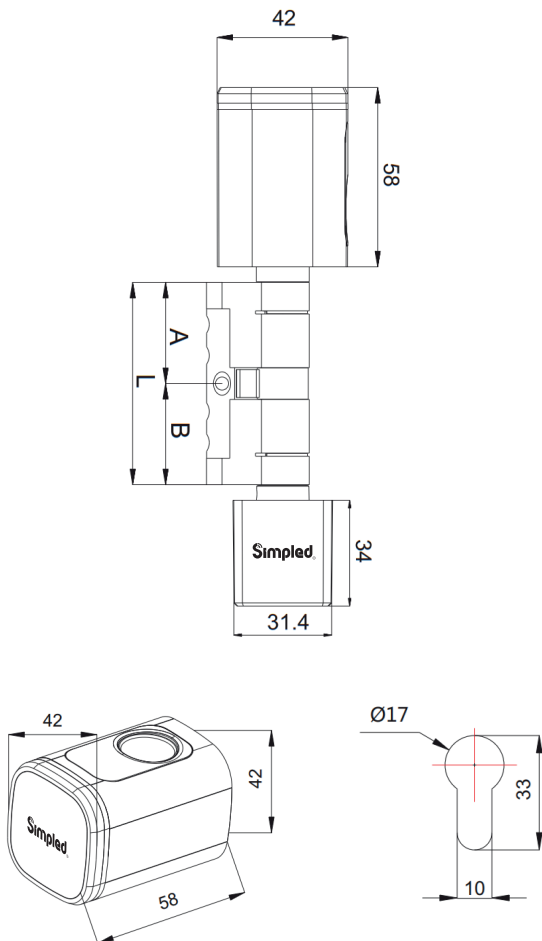

Notice after you insert the key into the key hole and turn clockwise, you shall turn the reader to unlock the door but not to use the key to unlock the door directly.

Installation Steps

If you have purchased lengthening rods, here's the video showing how to extend the cylinder length:

1. Please use the screw driver to take off the screw on the back knob position, refer the below Pic.1:

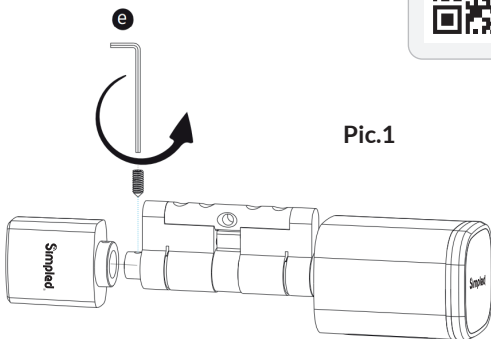

Pic.1

2. Please insert the cylinder to the existed lock and fix the cylinder with the long screw as Pic.2:

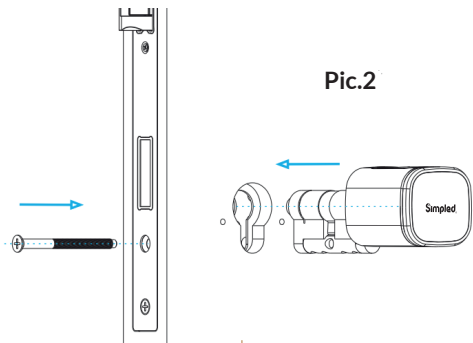

Pic.2

3. Please use the screw driver to fasten the screw on the back knob position, refer the below

Pic.3:

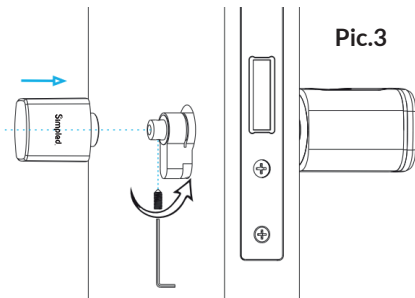

Pic.3

4. Please take off the reader cover with the magnet or sucker (included in our accessories bag) assemble 1xCR123a alkaline battery, refer the below

Pic.4:

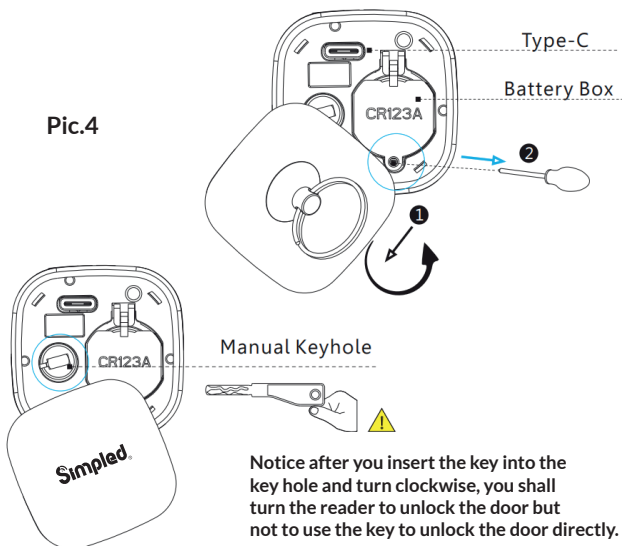

Pic.4

Notice after you insert the key into the key hole and turn clockwise, you shall turn the reader to unlock the door but not to use the key to unlock the door directly.

5. Please test with your fingerprint under the factory state, any fingerprint will unlock the door lock, refer the below Pic.5 :

Pic.5

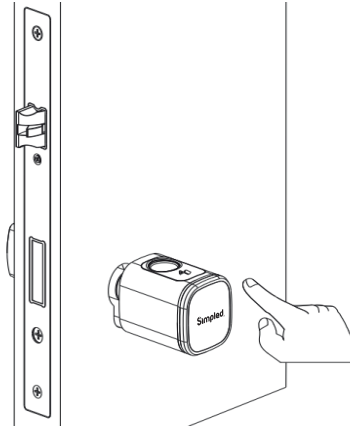

6. Please test the lock with key card after you configure the lock with TTlock APP (Refer to the app section-Add Fobs / Tags / Stickers).

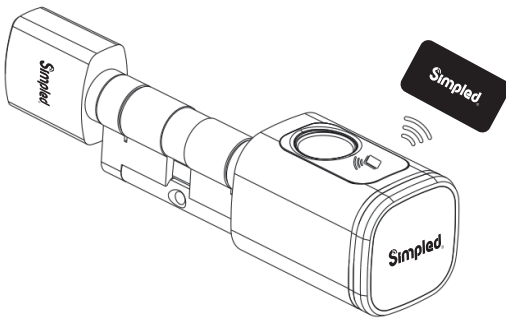

Setting up the Smart App

1. Download the "TTlock App" from the App Store or Google Play by either
 - Scanning the QR code
 - Searching the "TTLock" app
2. Sign up for a TTlock account, and add the smart lock to the device list

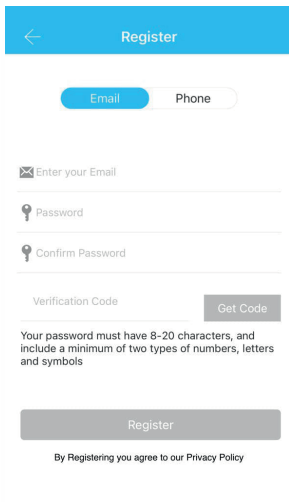

The Register screen features a blue header with a back arrow and the title "Register". Below the header are two tabs: "Email" (selected) and "Phone". The form includes fields for "Enter your Email", "Password", and "Confirm Password". A "Verification Code" field is present with a "Get Code" button. A note states: "Your password must have 8-20 characters, and include a minimum of two types of numbers, letters and symbols". At the bottom is a "Register" button and a link to the "Privacy Policy".

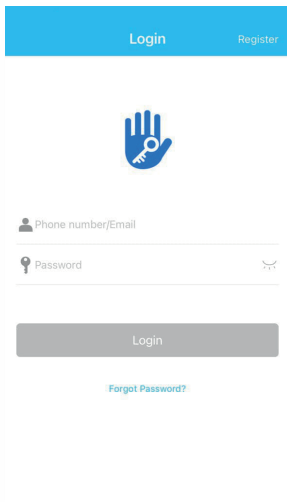

The Login screen features a blue header with the title "Login" and a "Register" link. Below the header is a blue hand icon with a keyhole. The form includes fields for "Phone number/Email" and "Password" (with a visibility toggle). A "Login" button is at the bottom, along with a "Forgot Password?" link.



Scan for more help!

You can register an account by your email address or mobile number that is available in 200 countries around the world.

3. Activate the lock's Bluetooth by touching the Lock's keypad
4. Tap on "+ Add Lock" and select your lock type. Press on "All Locks" if you are not sure.
5. In the "Nearby Locks" list, select the appeared lock. Please make sure you are near the lock in the Bluetooth range.
6. Rename the Lock "Sweet Home, Spain Villa, London Office, ..."

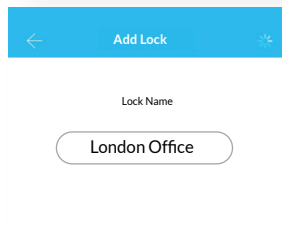
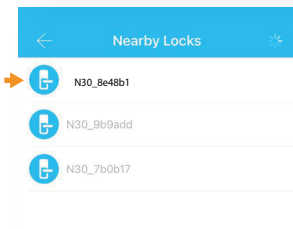
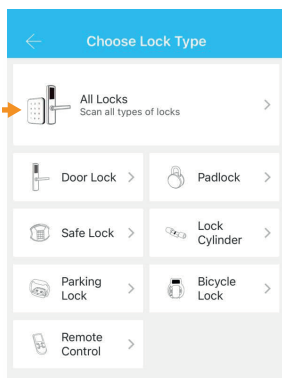
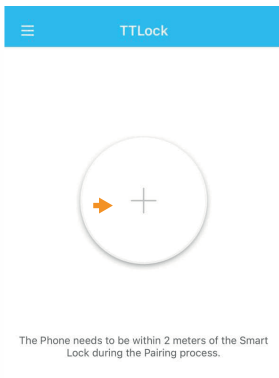

Notice: Generally, the passcode for a lock that has not yet been added is 123456

Bluetooth Unlock

Try to open the lock by tapping on the "Lock Icon". Please ensure there is no problem with Bluetooth communication, and the phone is within the 5-meter range of the Simplified Slim Smart Lock.

Add Fingerprints

For adding a new fingerprint,

1. Select Fingerprint from the lock screen in the app
2. Tap on the three dots
3. Select Add Fingerprint
4. Choose a name for later reference " It helps you to recognise the fingerprint in the unlocking reports".
5. Choose whether you want to create limited-time or permanent access.
6. Then start and press your fingerprint 4 times on the fingerprint sensor
7. You should see it is done successfully.
8. Test the fingerprint.

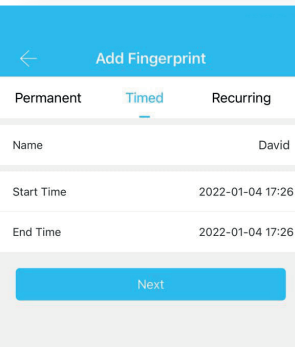
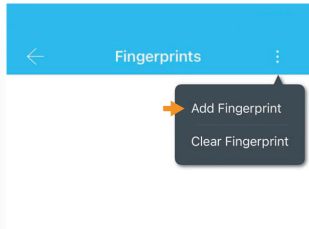
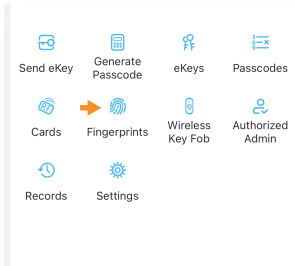

Add Passcodes (Wireless Keypad Sold Separately)

You can create different passcodes types to open the Simplified slim lock: permanent, time-limited, OTP(one-time passcode), cycle or custom. You can easily share the passcode with other users via SMS, Email, WhatsApp.

You can create, limit, share and delete a passcode without a bridge using the app when you are near the lock.

But for example, If you want to eliminate a passcode remotely, you need a Bridge. You can learn more about Bridge features in its section.

Gain access with Passcodes:

1. Touch the keypad with your palm or back of your fingers to wake up the lock.
2. Enter the generated passcode. (Before setting new passcodes, the default code is 123456#)
3. Press #.

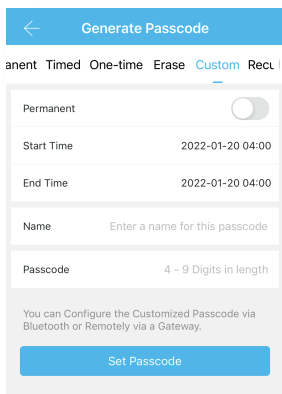
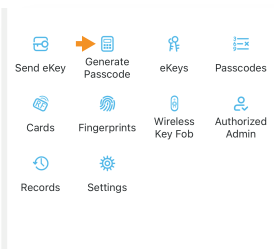

Passcode Management

Click on "Passcodes". In this section, the Admin user can

1. Change, delete or reset passcodes.
2. Review the unlock records of passcodes.

Create and Send e-Keys

By selecting the "Send eKey" as shown in the figure, you can create and share an electronic key with your friends, family, maid, dog walker or your Airbnb guests. For using the eKey, they need to download and sign up for a new account. This will also help you find out about the time they opened the lock. E-Keys are also available in different types: Permanent, Time-Limited, One-time and recurring.

You can authorise a user as Admin in the Authorised Admin section

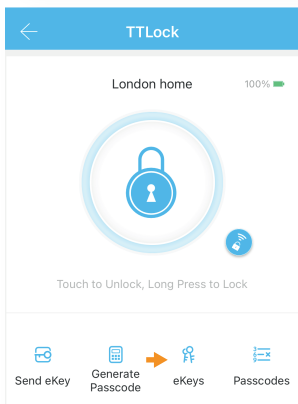
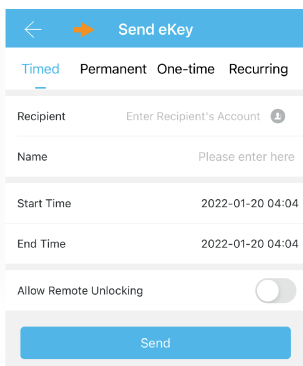
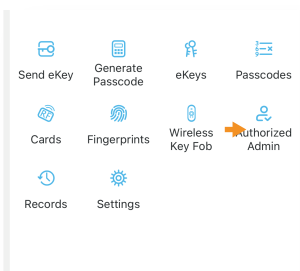

e-Key Management

Click on eKeys. In this section, the Admin user can

1. reset or delete eKeys.
2. review the access records.

Create Admin

With this feature, you can assign a new timed/ permanent admin to have the same level of access to the lock.

For example, your receptionist or even your guest will be able to add new users and even register their own fingerprint on the smart lock, up to the time their users are valid.

Programme Card, Proximity Fobs, Phone Tag Stickers:

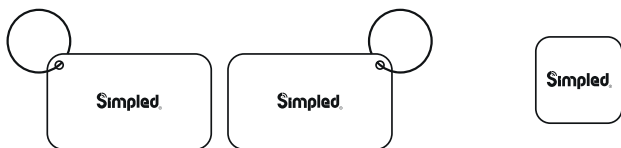

Before a proxy fob or sticker can open the lock, it is required to be programmed first. Fobs/Stickers can also be Permanent or Limited by time.

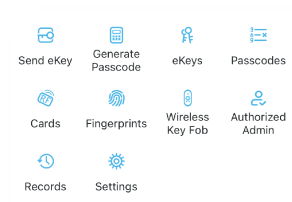

Unlocking Records

Tap on "records". In this part, you can review all the unlock records

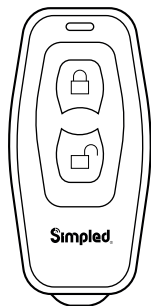
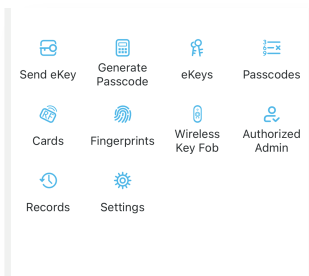

Pair Wireless Key Fob

(Bluetooth Remote Controller)- Not included

1. Tap on "Wireless Key Fob".
2. Add Key Fob
3. Use Permanent/Timed/Recurring Tab.
4. Long Press the Locking Key on the Remote controller for 5 seconds.
5. Tap "Next" when the light flashes quickly.

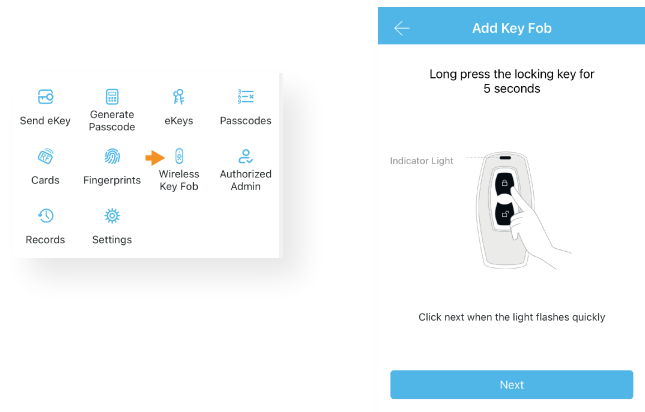

Activate Passage Mode

1. Choose the lock
2. Tap on "Settings"
3. Select "Passage Mode"
4. Turn on this mode and press Save

Note: To activate the passage mode, you need to unlock it once with the app!

When passage mode is activated, you can long-press # to force-lock the Simplified lock! It's the same when the auto-lock feature is off; you can long-press # to lock the door.

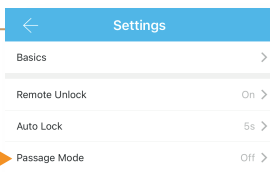

Import data from an old Simplified lock.

To transfer data from an old Simplified lock to a new one you can follow these steps:

1. Choose the new lock on the app.
2. Tap on "Settings"
3. Select "Import from another lock"
4. Choose your old lock from the list.

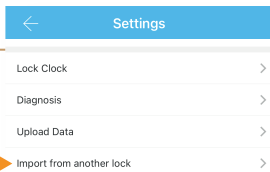

How to turn off/on the lock sound?

1. Open the app.
2. Tap on the lock.
3. Choose "Settings".
4. Disable/Enable the Lock sound.

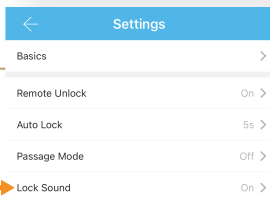

Transfer lock to a new owner

1. Open the app > 2. Tap on the ☰ (Top Left)
 3. Select "Settings" > 4. Tap on "Transfer Lock(s)"
 5. Select the lock(s) and press Next
 6. Enter the new owner Account, and press Next.
- Notice: The selected lock(s) will be permanently transferred.

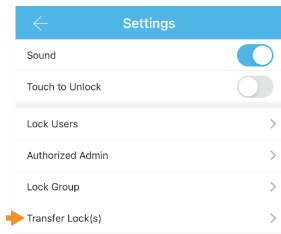
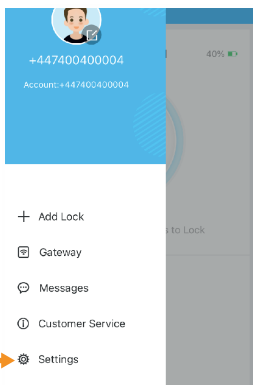

Wifi Bridge Pairing

The Simplified Smart WiFi Bridge is a bridge between Simplified Smart locks and WiFi. With the Gateway, you can

- open your lock from anywhere
- remotely read the lock operation records, including, fingerprint, passcodes
- calibrate the lock clock remotely
- remotely delete and modify passcodes
- use the Simplified lock with your Alexa
- use the Simplified lock with your Google home

Light Status

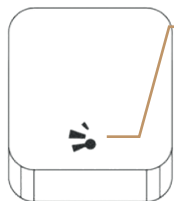

When the WiFi Bridge is powered on:

- Light Flashes alternately in Red and Blue: Stand-by mode, ready for pairing
- Blue light: Working mode
- Red Light: Network failure

Pair the Gateway with APP

1 Activate the APP



2 Pres "☰"

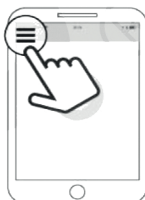

3 Select (Gateway)

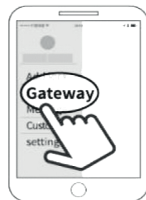

4 Select (G2)

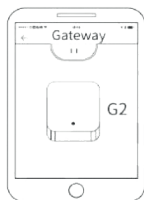

5 Plug in the Gateway and power it on, while the light Flashes alternately in red and blue

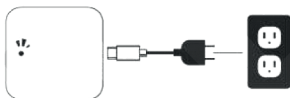

6 Press "+" sign



7 Add (Gateway)



8 Select the network and fill in the password



9 Add complete

Notice: If times out, please turn off and on, and try it again.

After pairing the WiFi Bridge, please turn on "Remote Unlock" on the TTlock settings.



Scan for more comprehensive TTlock app manual.

FAQ

1. How can I read the operation records?

1. Open the app
 2. Select your lock
 3. Select "Records"
-

2. After installation, I touched the Fingerprint sensor, but there was no response.

What is the reason?

- A) Check if the battery is placed correctly and if it has enough power. New Alkaline Batteries are recommended.
 - B) Check if the battery cover is fitted properly.
-

3. I had a problem registering my fingerprint.

Check if your fingerprints are clean without any dirt or wear.
Clean the sensor with a soft cloth making sure there's no oil, stains, etc.

Accessories

Want more Accessories? Here is all you want:



Lengthening Rods



More accessories?
SCAN HERE

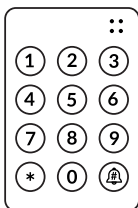

Keypad Lock

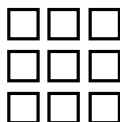

Another Smart lock
for other doors

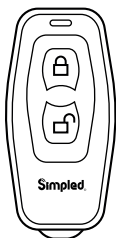

Bluetooth
Remote Controller

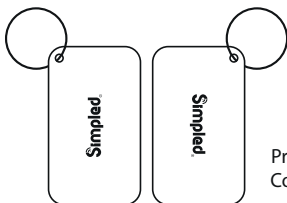

Proxy Fobs
Contactless Keys



Phone Tag (Sticker)
Contactless Key

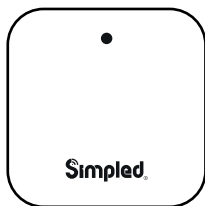

WiFi Bridge



Smart lock for
a friend or family

A series of horizontal dotted lines for writing, starting below a solid top line and extending to the bottom of the page.

Contact us:

Note:

1. We provide you with a two-year warranty from the date of purchase.
2. This warranty service is valid for customers in any country in the world.
3. For more help please contact us:
[Simplified.uk/support](https://simplified.uk/support)



We're just happy that you're happy.
If you don't know how to express your newfound joy, we've got a few suggestions...

WOW!



Tell your friends and family

OR



Share your experience by writing a review on Amazon



Connect with us on simplified.tech
Facebook, Twitter and Instagram



*Easy Amazon
Review
Scan me!*



Our friendly customer service team will work hard to put a smile back on your face.
Here's how we can connect:

MEH.



support@simplified.tech



[Simplified.uk/support](https://simplified.uk/support)